

MASTER COPY

TM 55-4920-243-35P

DEPARTMENT OF THE ARMY TECHNICAL MANUAL

DS, GS, AND DEPOT MAINTENANCE
REPAIR PARTS AND SPECIAL TOOLS LIST
MONITORING KIT, VIBRATION
P/N 171170-0104

FSN 4920-879-0331

HEADQUARTERS, DEPARTMENT OF THE ARMY

31 OCTOBER 1968

*U.S. GOVERNMENT PRINTING OFFICE: 1968-342-011/1090

C/ 31 MAR 93

STOCK NUMBER APPROXIMATE — 1968

CHANGE

No. 1

HEADQUARTERS
DEPARTMENT OF THE ARMY
WASHINGTON, D.C., 31 MARCH 1993

**DS, GS, AND DEPOT MAINTENANCE
REPAIR PARTS AND SPECIAL TOOLS LIST**

MONITORING KIT, VIBRATION

P/N 171170-0104

NSN 4920-00-879-0331

DISTRIBUTION STATEMENT A: Approved for public release; distribution is unlimited.

TM 55-4920-243-35P, 31 October 1968, is changed as follows:

Page iii, para 6, change ATTN: line to, "AMSAT-I-MP, 4300 Goodfellow Blvd., St, Louis, Missouri 63120-1798."

Page 8, Figure 6,7, and 9, column 3 DESCRIPTION, Change "T53-L-9/11/13" to "T53-L-9/11."

By Order of the Secretary of the Army:

Official:

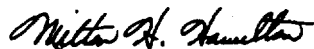

MILTON H. HAMILTON

*Administrative Assistant to the
Secretary of the Army*

03632

GORDON R. SULLIVAN
*General, United States Army
Chief of Staff*

DISTRIBUTION:

To be distributed in accordance with DA Form 12-31-E, block no. 2089, requirements for TM 55-4920-243-35P.

1/(2 blank)

TECHNICAL MANUAL

No. 55-4920-243-35P

HEADQUARTERS
DEPARTMENT OF THE ARMY
Washington, D. C., 31 October 1968

MONITORING KIT, VIBRATION

P/N 171170-0104

CURRENT AS OF 26 JUNE 1968

Table of Contents

SECTION	DESCRIPTION	PAGE
I	INTRODUCTION	ii
II	REPAIR PARTS	1
GROUP		
01	Monitoring Kit Accessory	1
02	Cable Assembly	1
03	Vibration Transducer.	1
04	Vibration Transducer Adapters	8
05	Vibration Meter	15
06	Terminal Board Assembly	16
SECTION		
III	SPECIAL TOOLS, TEST AND SUPPORT EQUIPMENT (NOT APPLICABLE)	
IV	INDEX	
PART		
1	Federal Stock Number Index.	19
2	Reference Number Index	20

SECTION I INTRODUCTION

1. Scope

This manual lists repair parts required for the performance of direct support, general support, and depot maintenance of Monitoring Kit, Vibration, Consolidated Electrodynamics Corp. P/N 171170-0104. It is to be used for identification, issue, requisitioning and as an aid to procurement.

2. General

This Repair Parts and Special Tools List is divided into the following sections —

a. Repair Parts — Section II. A list of repair parts authorized for the performance of maintenance at direct support, general support, and depot level in figure and item number sequence within each functional group.

b. Special Tools, Test and Support Equipment — Section III. (Not Applicable).

c. Index — Section IV. This section is divided into the following parts —

- (1) Federal Stock Number Index – Part 1. A list of Federal stock numbers in ascending numerical sequence appearing in all listings cross-referenced to figure item number.
- (2) Reference Number Index – Part 2. A list of reference numbers in alpha-numerical sequence appearing in all listings cross-referenced to manufacturers code and figure and item number.

3. Explanation of Columns

The following provides an explanation of columns in the tabular lists in Section II.

u. Source, Maintenance, and Recoverability Codes (SMR).

- (1) Source Code. Indicates the selection status and source for the listed item. The source code used is —

<i>Code</i>	<i>Explanation</i>
P	Applies to repair parts which are stocked in or supplied from General Services Administration/Defense Supply Agency or Army supply system and are authorized for use at indicated maintenance categories.

- (2) Maintenance Code. Indicates the lowest category of maintenance authorized to install the listed item. Parts which require manufacture or assembly will be

indicated in the source code column the category which will make or assemble the item (i.e., AF, MF). The maintenance code used is —

<i>code</i>	<i>Explanation</i>
F	Direct Support

- (3) Recoverability Code. Indicates whether unserviceable items should be returned for recovery or salvage. Items not coded are expendable. The recoverability code used is —

<i>Code</i>	<i>Explanation</i>
R	Applies to repair parts and assemblies which are economically repairable at DSU/GSU activities and normally are furnished by supply on an exchange basis.

b. Federal Stock Number. Indicates the Federal stock number assigned to the item and will be used for requisitioning purposes.

c. Description. Indicates the Federal item name and any additional description of the item required. Further information to clarify item relationship, item replacement, multiple application and material required for fabrication is also identified.

- (1) Reference Number. A part number or other reference number followed by the applicable five-digit Federal supply code for manufacturers in parentheses.
- (2) Models Useable On. Indicates the usable on code to identify models. This subcolumn is not applicable to this publication.

d. Unit of Issue (U/I). A two character alphabetic abbreviation indicating the amount or quantity of the item upon which the allowances are based, e.g., FT, EA, PR, etc.

e. Quantity Incorporated in Unit Pack. (Not Applicable)

f. Quantity Incorporated in Unit. Indicates the quantity of the item used in the functional group. A “V” appearing in this column in lieu of a quantity indicates that a definite quantity cannot be indicated, (e.g., shims, spacers, etc.).

g. 30 - Day DS/GS Maintenance Allowances.

- (1) The allowance columns are divided into three subcolumns. Indicated in each subcolumn,

opposite the first appearance of each item, is the total quantity of items authorized for the number of equipments supported. Subsequent appearances of the same item will have the letters "REF" in the allowance column. Items authorized for use as required, but not for initial stockage are identified with an asterisk (*) in the allowance column.

- (2) The quantitative allowance for DS/GS levels of maintenance will represent initial stockage for a 30-day period for the number of equipments supported.
- (3) Determination of the total quantity of parts required for the maintenance of more than 100 of these equipments can be accomplished by converting the equipment quantity to a decimal factor by placing a decimal point before the next to last digit of the number to indicate hundredths, and multiplying the decimal factor by the parts quantity authorized in the 51-100 allowance column. Example, authorized allowance for 51-100 equipment is 40; for 150 equipments multiply 40 by 1.50 or 60 parts required.

h. 1- *Year Allowance Per 100 Equipments/ FIG Contingency Planning Purposes.* When applicable, this column indicates opposite the first appearance of each item the total quantity required for distribution and contingency planning purposes. The range of items indicates the total quantities of all authorized items required to provide adequate support of 100 equipments for one year.

5. Federal Supply Code for Manufacturer

<i>Code</i>	<i>Manufacturer and Location</i>
09384	Consolidated Electroynamics Corp Data Instruments Division Transducer Products 1400 S Shamrock Monrovia Calif 91016
14028	Consolidated Electroynamics Corp Data Instruments Division Datatape-Datagraph Products 360 Sierra Madre Villa Ave Pasadena Calif 91109
14655	Cornell-Dubilier Electric Corp 50 Paris Street Newark N J
27191	Cutler-Hammer Inc Power Distribution and Control Division 4201 N 27th St Milwaukee Wis 53216
37942	Mallory P R and Co Inc 3029 East Washington St Indianapolis Ind 46206
55026	Simpson Electric Co 5200 W Kinzie Chicago Ill
56289	Sprague Electric Co Marshall St North Adams Mass 01247
71400	Bussmann Mfg Division of McGraw-Edison Co 2536 W University St St Louis Mo 63017
75915	Littlefuse Inc 800 E Northwest Hwy Des Plaines Ill 60016
81349	Military Specifications Promulgated By Standardization Div Directorate of Logistic Services DSA
88044	Aeronautical Standards Group Dept of Navy and Air Force
91547	AVCO/Lycoming Division Stratford Plant 550 S Main St Stratford Conn
91929	Honeywell Inc Micro-Switch Division Chicago and Spring Street Freeport Ill 61032
96906	Military Standards Promulgated By Standardization Div Directorate of Logistic Services DSA

6. Recommendations for Equipment Manual Improvements.

Report of errors, omissions, and recommendations for improving this publication by the individual user is encouraged. Reports should be submitted on DA Form 2028 (Recommended Changes to DA Publications) and forwarded direct to the Commanding General, U. S. Army Aviation Systems Command, ATTN: AMSAT-I-MP, 4300 Goodfellow Blvd., St. Louis, Missouri 63120-1798.

vide adequate support of 100 equipments for one year.

i. *Depot Maintenance Allowance Per 100 Equipments.* Indicates opposite the first appearance of each item, the total quantity authorized for depot maintenance of 100 equipments. Subsequent appearances of the same item will have the letters "REF" in the allowance aolumn. Items authorized for use as required, but not for initial stockage are identified with an asterisk (*) in the allowance column.

j. *Illustrations.*

- (1) Figure Number. Indicates the figure number of the illustration in which the item is shown.
- (2) Item Number. Indicates the call-out numbers used to reference the item in the illustration.

4. Abbreviations (Mnemonic Codes)

The following abbreviations are used —

AMP	Ampere(s)
C/O	Consist of
CPS	Cycles per second
DC	Direct current
FIG	Figure
IN	Inch(es)
LG	Long (length)
MEGO	Megohm
RPLS-	Replaces
UF	Mircofarad(s)
V	Volt(s)
W	Watt(s)

SECTION II

(1) SOURCE, MAINT AND REC CODE (A) SOURCE CODE			(2) FEDERAL STOCK NUMBER (B) MAINT LEVEL (C) REC CODE			(3) DESCRIPTION REFERENCE NUMBER			(4) MODELS USABLE ON	(5) UNIT OF ISSUE	(6) QTY INC IN UNIT PACK		(7) 30-DAY DS/GS MAINT ALW (A) (B) (C)			(8) 1-YR ALW PER 100 EQUIP CNTGCV		(9) DEPOT MAINT ALW PER 100 EQUIP		(10) ILLUSTRATION (A) (B) FIG ITEM NO NO	
P	F		4920-879-0331	171170-0104	(09384)	MONITORING KIT, VIBRATION ENGINE, T53,T55 & T63 TURBINE ENGINE	EA												1		
SECTION II REPAIR PARTS																					
GROUP 01 MONITORING KIT ACCESSORY																					
P	F		5935-081-8025	CEC171581	(14028)	ADAPTER, CONNECTOR, GROUNDING, INPUT. LINE	EA		1	*	*	*				*			1	1	
GROUP 02 CABLE ASSEMBLY																					
P	F		4920-981-5089	49657-0900	(09384)	CABLE, ADAPTER, VIBRATION, TRANSDUCER TO VIBRATION METER, 900 IN. LG	EA		2	*	*	*				*			1	2	
P	F		4920-083-0409	CEC49657-0300	(14028)	CABLE ASSEMBLY, SPECIAL PURPOSE, TRANSDUCER TO VIBRATION METER	EA		3	*	*	*				*			1	3	
GROUP 03 VIBRATION TRANSDUCER																					
P	F		4920-082-0436	4-128-0101	(09384)	TRANSDUCER, VIBRATION PICK-UP SELF-GENERATING, 15 TO 1500 EPS C/O	EA		3	*	*	*				*			2		
1 EA CASE, P/N 360283-0003																					
1 EA SPRING, COMPRESSION, P/N 361597																					
1 EA MAGNET ASSEMBLY, P/N 360069																					
1 EA SLEEVE, P/N 360081																					
1 EA BOBBIN ASSEMBLY, P/N 360282																					
1 EA GASKET, P/N 363129																					
1 EA COVER, P/N 363170																					
4 EA WASHER, FLAT, GOLF, P/N 360090																					
4 EA SCREW, MACHINE, P/N 166648-1304																					
1 EA SETSCREW, P/N 85529-7200																					
1 EA CABLE ASSEMBLY, P/N 169760-0036																					
1 EA STRAIN RELIEF, P/N 28103																					
1 EA CABLE, P/N 31833																					
1 EA BUSHING, P/N AN3420-3																					
1 EA BUSHING, P/N AN3420-4																					
1 EA CONNECTOR, P/N XK3-12																					

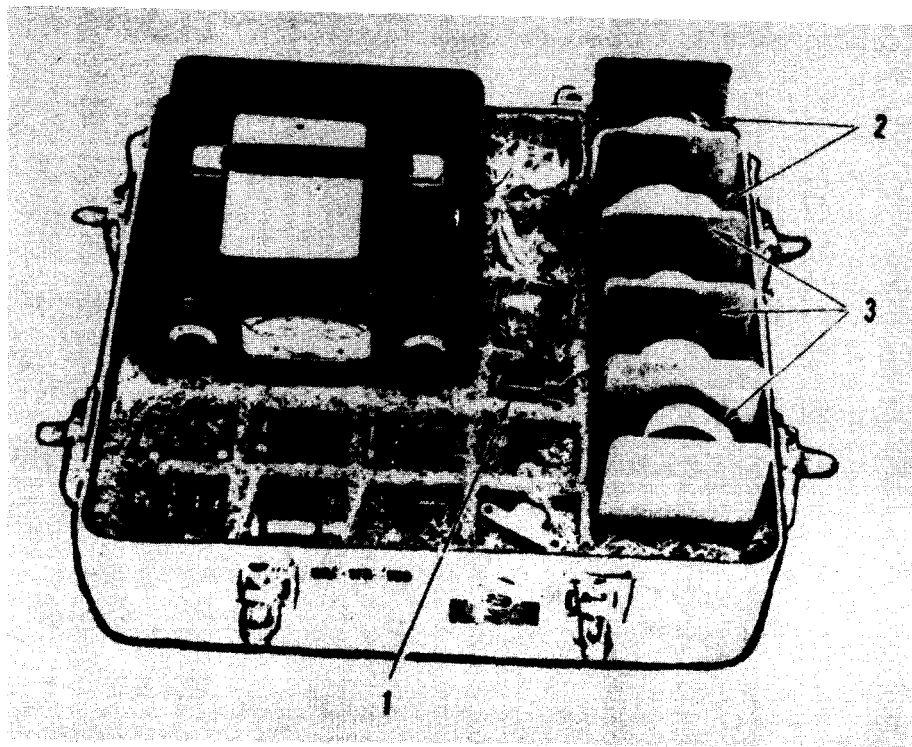

Figure 1. Vibration Monitoring Kit.

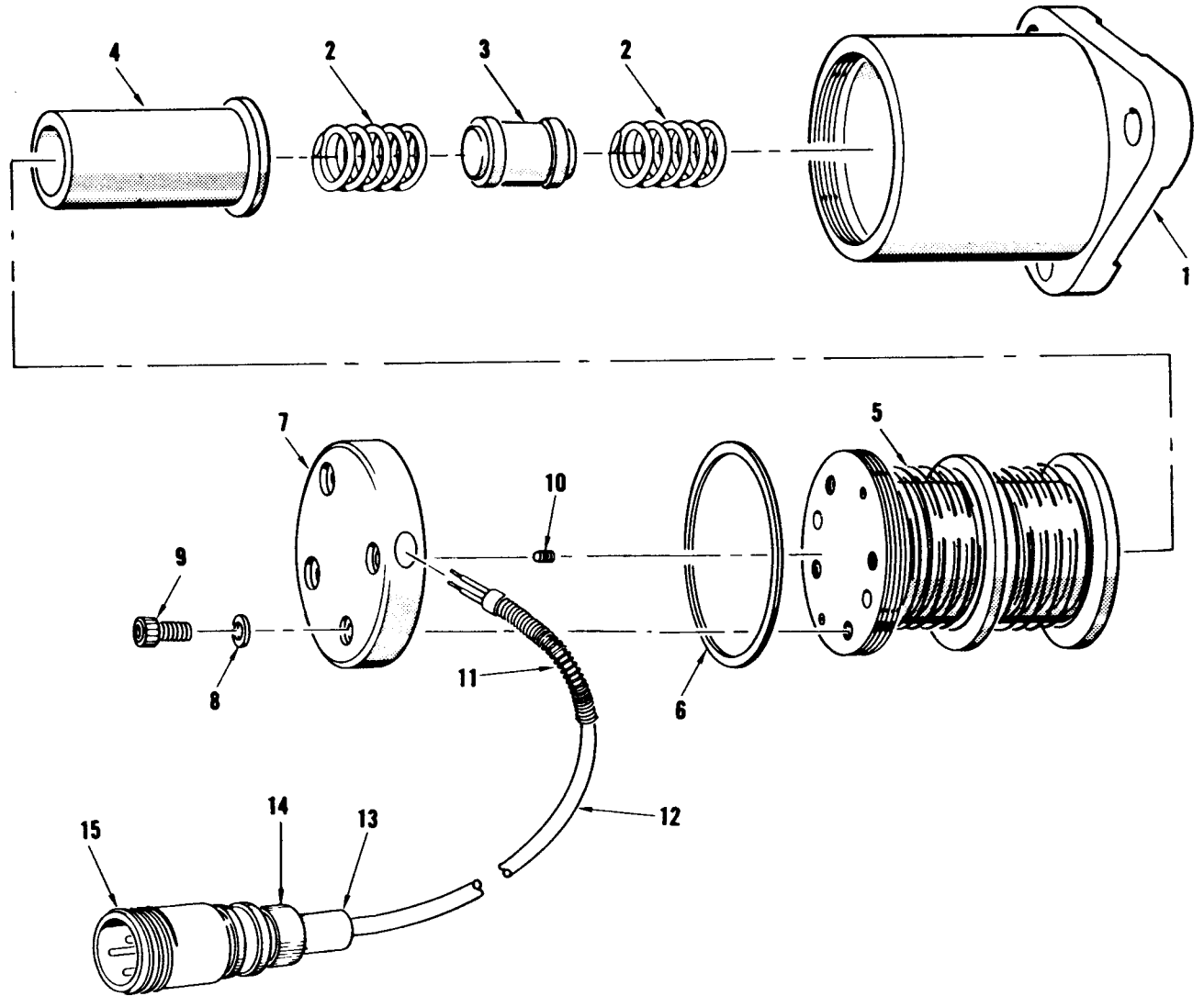

Figure 2. Velocity Vibration Transducer.

TM55-4920-243-35P

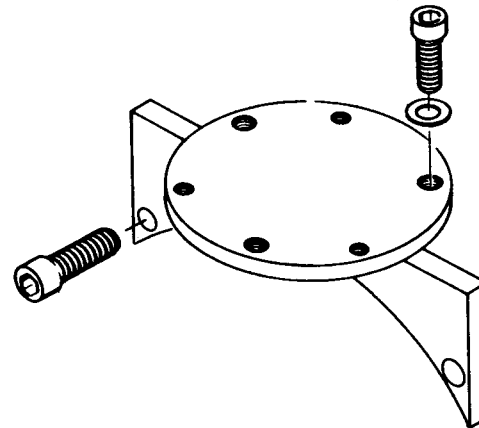

Figure 3. Vibration Transducer Compressor Bracket.

TM55-4920-243-35P

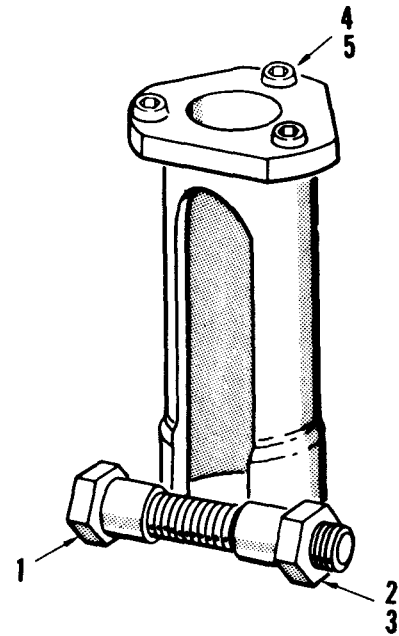

Figure 4. Vibration Transducer Power Turbine Adapter.

TM55-4920-243-35P

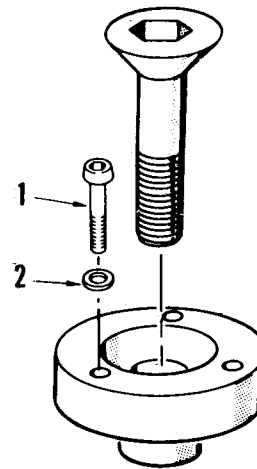

Figure 5. Vibration Transducer Adapter.

7

TM55-4920-243-35P

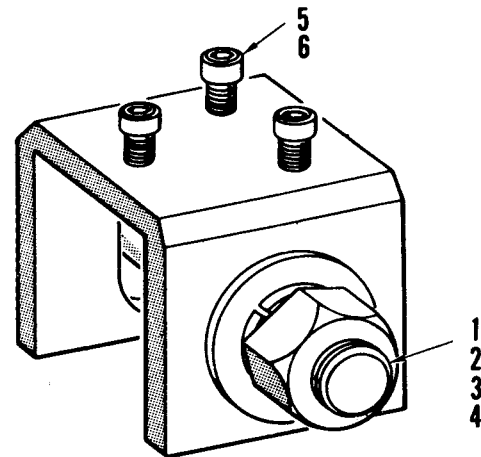

Figure 6. Vibration Transducer Inlet Housing Adapter.

7

SECTION II

(1)			(2)	(3)				(4)	(5)	(6)	(7)			(8)	(9)	(10)	
SOURCE, MAINT AND REC CODE			FEDERAL STOCK NUMBER	DESCRIPTION				UNIT OF ISSUE	QTY INC IN UNIT	QTY INC IN UNIT	30-DAY DS/GS MAINT ALW			1-YR ALW PER 100 EQUIP CNTGCV	DEPOT MAINT ALW PER 100 EQUIP	(A) FIG NO	(B) (B) ITEM NO
(A) SOURCE CODE	(B) MAINT LEVEL	(C) REC CODE	NUMBER	REFERENCE NUMBER	MODELS USABLE ON	UNIT OF ISSUE	QTY INC IN UNIT	QTY INC IN UNIT	UNIT	(A) 1-20	(B) 21-50	(C) 51-100	EQUIP CNTGCV	ALW PER 100 EQUIP	MAINT ALW PER 100 EQUIP	(A) FIG NO	(B) ITEM NO
GROUP 04 VIBRATION TRANSDUCER ADAPTERS																	
P	F		4920-082-0446	362855 (09384)	BRACKET, VIBRATION PICK-UP COMPRESSOR SECTION, T63-A-5 ENGINE, NO. 1 TRANSDUCER	EA	1	*	*	*				*		3	
P	F		4920-856-6088	CEC171579 (14028)	MOUNT, VIBRATION PICK-UP, POWER TURBINE OIL FEED LINE, NO. 3 TRANSDUCER, T53-L-3/7 ENGINE	EA	1	*	*	*				*		4	
P	F		5306-826-3719	AN101022 (88044)	. BOLT, MACHINE	EA	1	*	*	*				*		4	1
P	F		5310-167-0834	AN960-10L (88044)	. WASHER, FLAT	HD	1	*	*	*				*		4	2
P	F		5310-061-7326	MS21045-3 (96906)	. NUT, SELF-LOCKING, HEXAGON	HD	1	*	*	*				*		4	3
P	F		5305-978-9343	MS16997-10 (96906)	. SCREW, CAP, SOCKET HEAD	EA	3	*	*	*				*		4	4
P	F		5310-543-2410	MS35338-40 96906	. WASHER, LOCK	HD	3	*	*	*				*		4	5
P	F		4920-509-8078	CEC171576 (14028)	ADAPTER, VIBRATION PICK-UP, REAR LIFTING POINT HOIST ADAPTER, NO. 2 TRANSDUCER, T55-L-5/7 ENGINE	EA	1	*	*	*				*		5	
P	F		5305-978-9343	MS16997-10 (96906)	. SCREW, CAP, SOCKET HEAD	EA	3	*	*	*				*		5	1
P	F		5310-543-2410	MS35338-40 (96906)	. WASHER, LOCK	HD	3	*	*	*				*		6	
P	F		4920-858-0016	CEC171575 (14028)	ADAPTER, INLET HOUSING, FRONT LIFTING EYE, NO. 1 TRANSDUCER, T-53-L-9/11 ENGINE	EA	1	*	*	*				*		6	
P	F		5306-180-0097	AN8-23A (88044)	. BOLT, MACHINE	EA	1	*	*	*				*		6	1
P	F		5310-167-0823	AN960-816 (88044)	. WASHER, FLAT	HD	1	*	*	*				*		6	2
P	F		5310-045-3298	MS35337-48 (96906)	. WASHER, LOCK	EA	1	*	*	*				*		6	3
P	F		5310-298-9267	AN315-8R (88044)	. NUT, PLAIN, HEXAGON	LL	1	*	*	*				*		6	4
P	F		5305-978-9343	MS16997-10 (96906)	. SCREW, CAP, SOCKET HEAD	EA	3	*	*	*				*		6	5
P	F		5310-543-2410	MS35338-40 (96906)	. WASHER, LOCK	HD	3	*	*	*				*		6	6
P	F		4920-972-6118	CEC171574 (14028)	ADAPTER, ASSEMBLY, VIBRATION PICK-UP, RPLS- P/N CEC171573, DIFFUSER FLANGE, TOP POSITION, NO. 2 TRANSDUCER, T53-L-9/11 ENGINE	EA	1	*	*	*				*		7	
P	F		5306-297-0039	AN101014 (88044)	. BOLT, MACHINE	HD	2	*	*	*				*		7	1
P	F		5310-061-7326	MS21045-3 (96906)	. NUT, SELF-LOCKING, HEXAGON	HD	2	*	*	*				*		7	2
P	F		5305-978-9343	MS16997-10 (96906)	. SCREW, CAP, SOCKET HEAD	EA	3	*	*	*				*		7	3
P	F		5310-543-2410	MS35338-40 (96906)	. WASHER, LOCK	HD	3	*	*	*				*		7	4
P	F		4920-082-0440	362854 (09384)	BRACKET, VIBRATION PICK-UP, GAS PRODUCE SUPPORT TO POWER TURBINE SUPPORT, NO. 2 TRANSDUCER, T-63-A-5 ENGINE	EA	1	*	*	*				*		8	
P	F		4920-996-7421	CEC171578 (91547)	ADAPTER, VIBRATION PICK-UP, POWER TURBINE OIL FEED LINE, NO. 3 TRANSDUCER, T53-L-9/11 ENGINE	EA	1	*	*	*				*		9	
P	F		4920-976-9318	CEC171580 (14028)	ADAPTER, VIBRATION PICK-UP, INLET HOUSING, NO. 1 TRANSDUCER, T55-L-5/7 ENGINE	EA	1	*	*	*				*		10	
P	F		5305-978-9343	MS16997-10 (96906)	. SCREW, CAP, SOCKET HEAD	EA	3	*	*	*				*		10	1
P	F		5310-543-2410	MS35338-40 (96906)	. WASHER, LOCK	HD	3	*	*	*				*		10	2

TM55-4920-243-35P

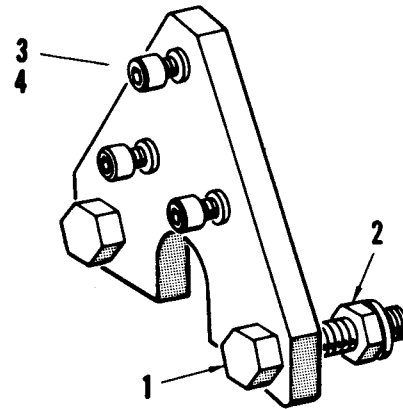

Figure 7. Vibration Transducer Combustion Flange Adapter Assembly.

TM55-4920-243-35P

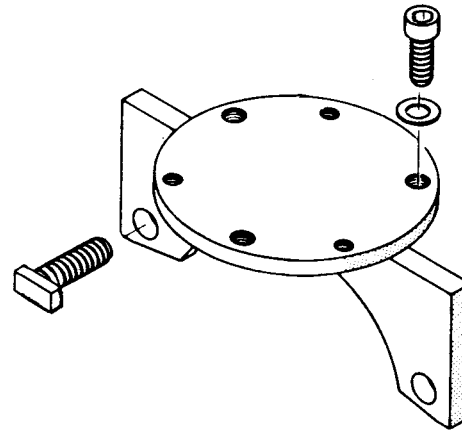

Figure 8. Vibration Transducer Turbine Bracket.

TM55-4920-243-35P

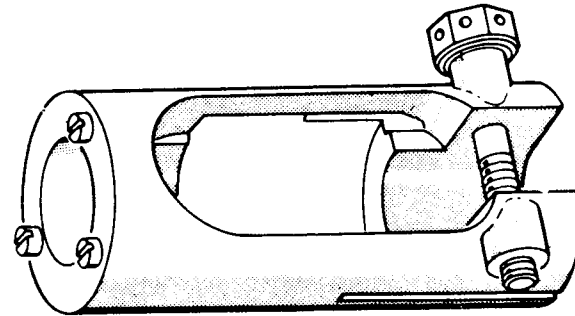

Figure 9. Vibration Transducer Power Turbine Adapter.

TM55-4920-243-35P

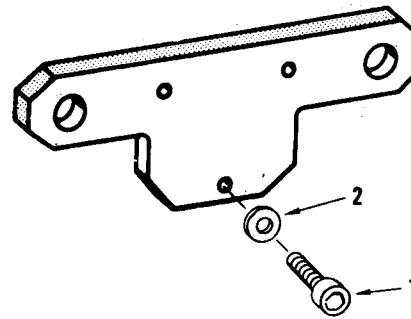

Figure 10. Vibration Transducer Adapter.

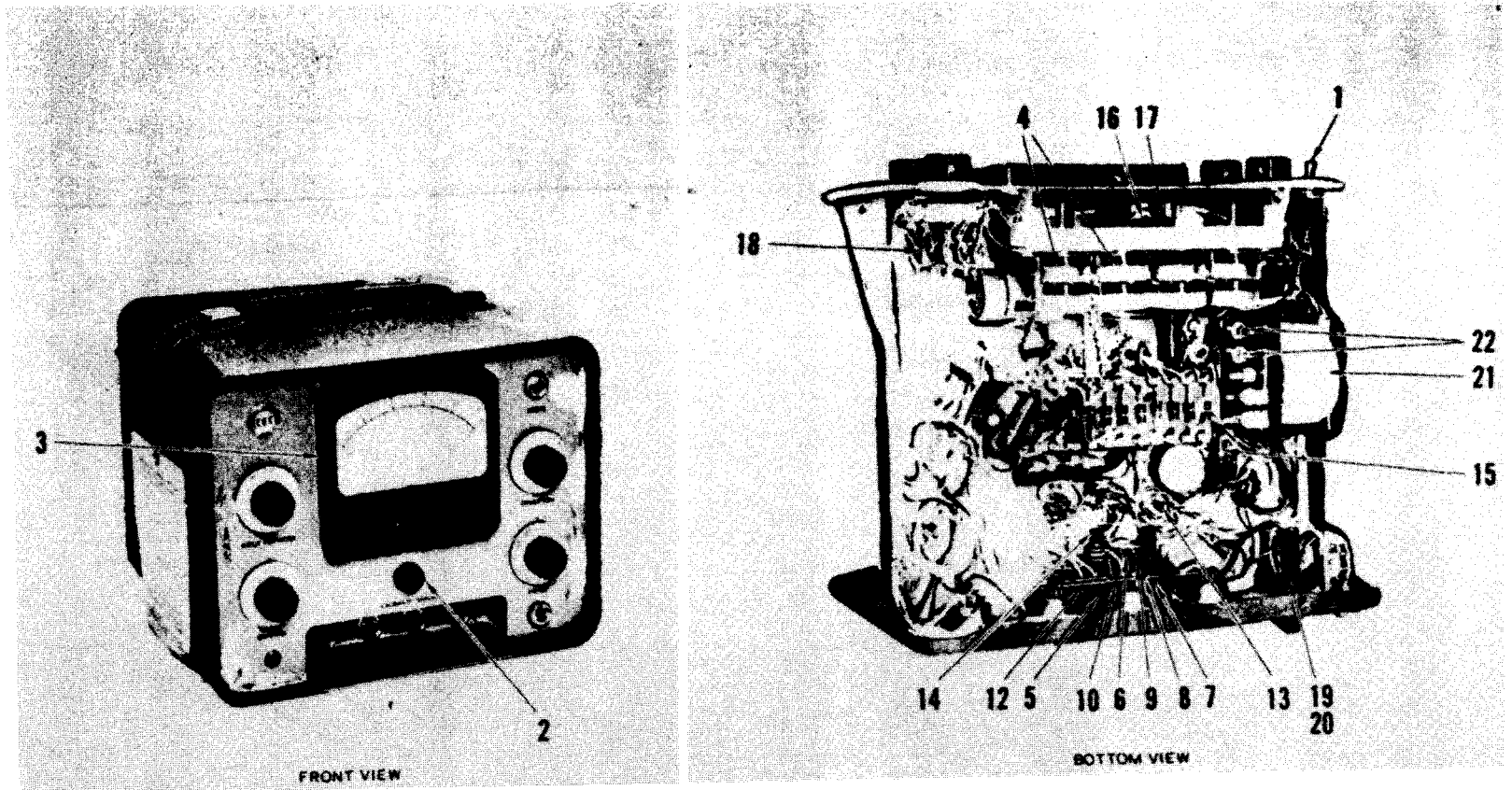

Figure 11. Vibration Meter (Sheet 1 of 2).

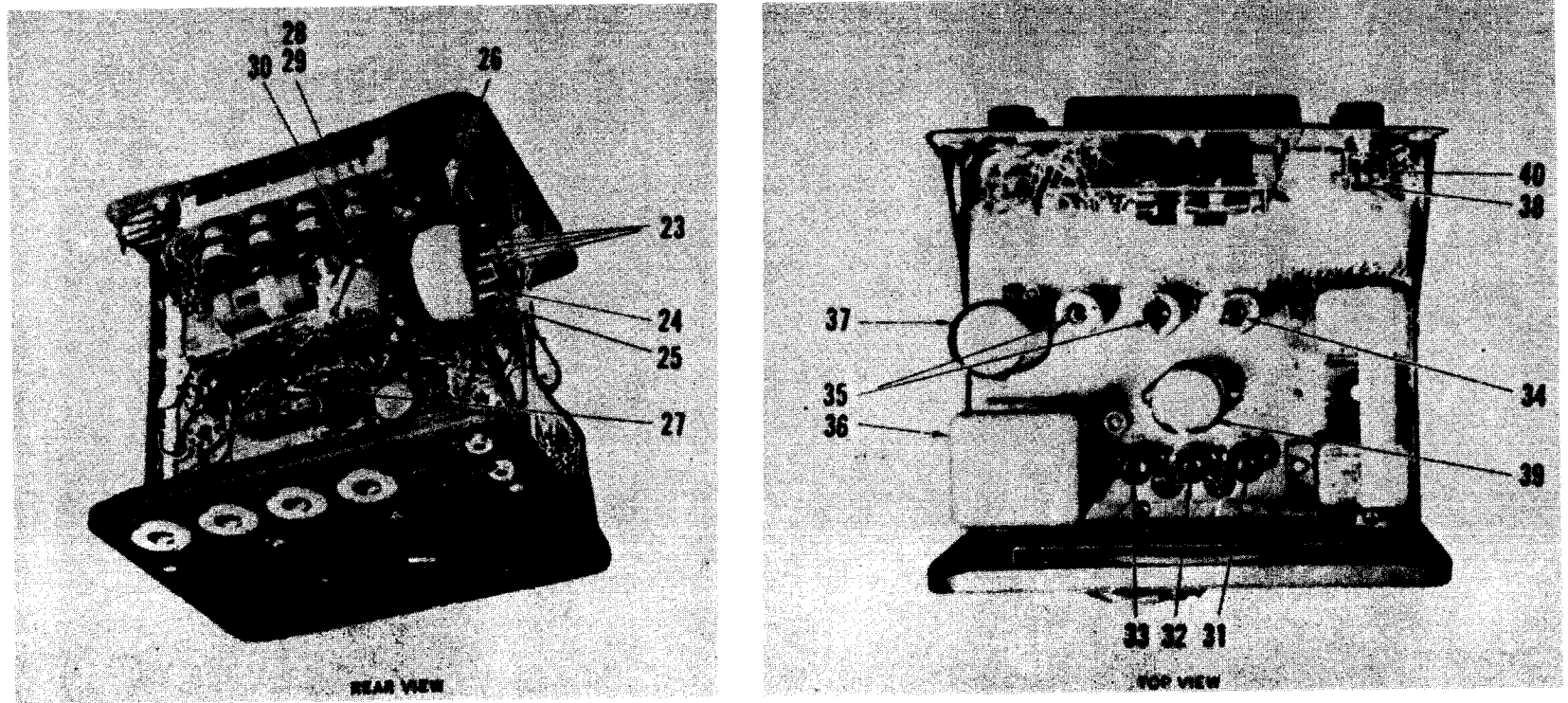

Figure 11. Vibration Meter (Sheet 2 of 2).

SECTION II

(1) SOURCE, MAINT AND REC CODE			(2) FEDERAL STOCK NUMBER		(3) DESCRIPTION REFERENCE NUMBER		(4) MODELS USABLE ON	(5) UNIT OF ISSUE	(6) QTY INC IN UNIT PACK	(7) 30-DAY DS/GS MAINT ALW (A) (B) (C) 1-20 21-50 51-100			(8) 1-YR ALW PER 100 EQUIP CNTGNCY	(9) DEPOT MAINT ALW PER 100 EQUIP	(10) ILLUSTRATION (A) (B) FIG ITEM NO NO	
GROUP 05 VIBRATION METER																
P	F	R	6625-590-6502	1-117-0105	(09384)	VIBRATION METER	EA	1	*	*	*		*		11	
P	F		5930-232-6545	8280K14	(27191)	.SWITCH, TOGGLE, S5, POWER ON-OFF	EA	1	*	*	*		*		11	1
P	F		5330-579-3156	MS28775-116	(96906)	.PACKING, PREFORMED, CALIBRATE SIGNAL CONTROL SHAFT	EA	1	*	*	*		*		11	2
P	F		6625-899-8069	34605	(55026)	.METER, ARBITRARY SCALE, 0 TO 500 MICROAMPERES, DC	EA	1	*	*	*		*		11	3
P	F		5905-899-5035	30624	(09384)	.RESISTOR ASSEMBLY, R11, 13, 14, 15, SENSITIVITY CONTROLS	EA	4	*	*	*		*		11	4
P	F		5910-899-7112	109P10494	(56289)	.CAPACITOR, FIXED, METALIZED PAPER DIELECTRIC, C8, 400 V DE, 0.1 UF	EA	1	*	*	*		*		11	5
P	F		5910-849-5205	109P68394	(56289)	.CAPACITOR, FIXED, METALIZED PAPER DIELECTRIC, C5, 400 V, 0.068 UF	EA	1	*	*	*		*		11	6
P	F		5905-279-3505	RC20GF392J	(81349)	.RESISTOR, FIXED, COMPOSITION, R41, 3900 OHMS, 1/2 W, SELECTED	EA	1	*	*	*		*		11	7
P	F		5905-279-2518	RC20GF434J	(81349)	.RESISTOR, FIXED, COMPOSITION, R40, 430,000 OHMS, 1/2 W	EA	1	*	*	*		*		11	8
P	F		5905-279-2515	RC20GF474J	(81349)	.RESISTOR, FIXED, COMPOSITION, R46, 470,000 OHMS, 1/2 W	EA	1	*	*	*		*		11	9
P	F		5905-249-3656	RC20GF623J	(81349)	.RESISTOR, FIXED, COMPOSITION, R44, 62,000 OHMS, 1/2 W	EA	1	*	*	*		*		11	10
P	F		5905-249-3661	RC20GF683J	(81349)	.RESISTOR, FIXED, COMPOSITION, R49 68,000 OHMS, 1/2W	EA	1	*	*	*		*		11	11
P	F		5905-195-6761	RC20GF104J	(81349)	.RESISTOR, FIXED, COMPOSITION, R43,	EA	1	*	*	*		*		11	12
P	F		5905-256-3361	RC42GF102J	(81349)	.RESISTOR, FIXED, COMPOSITION, R42, 1,000 OHMS, 2 W	EA	1	*	*	*		*		11	13
P	F		5905-249-3642	RC42GF393J	(81349)	.RESISTOR, FIXED, COMPOSITION, R45, 3,900 OHMS, 2 W	EA	1	*	*	*		*		11	14
P	F		5905-279-1937	RC42GF200J	(81349)	.RESISTOR, FIXED, COMPOSITION, R50, 20 OHMS, 2 W	EA	1	*	*	*		*		11	15
P	F		5930-583-8861	11SM1T	(91929)	.SWITCH, MICR, S6 PRESSURE SENSITIVE, CALIBRATE SIGNAL CONTROL	EA	1	*	*	*		*		11	16
P	F		5930-201-4429	JS5	(91929)	.ADAPTER, SWITCH, ACTUATOR, MICRO SWITCH	EA	1	*	*	*		*		11	17
P	F		5930-071-0924	30606	(09384)	.SWITCH, SELECTOR, S1, CHANNEL SELECTOR	EA	1	*	*	*		*		11	18
P	F		5920-636-4542	342001	(75915)	.FUSEHOLDER, INPUT POWER FUSE	EA	1	*	*	*		*		11	19
P	F		5920-280-8342	F02A250V1A	(81349)	.FUSE, CARTRIDGE, LAMP 250 V, INPUT FOR 230 V OPERATION	EA	1	*	*	*		*		11	20
P	F		5920-280-8344	AGC1-2	(71400)	.FUSE, CARTRIDGE, 1/2 AMP, 115 V, INPUT FOR 115 V OPERATION TERMINAL BOARD ASSEMBLY NO.1 SEE FIG 12 FOR BREAKDOWN	EA	1	*	*	*		*		11	20
P	F		5950-849-9394	33356	(09384)	.COIL, VIBRATOR, L1, FILAMENT CHOKE	EA	1	*	*	*		*		11	21
P	F		6625-070-7925	IN536	(14028)	.DIODE, SEMICONDUCTOR, CR5, 6, 7, 8, DC FILAMENT SUPPLY	EA	4	*	*	*		*		11	22

SECTION II

(1) SOURCE, MAINT AND REC CODE (A) (B) (C) SOURCE MAINT REC CODE LEVEL CODE			(2) FEDERAL STOCK NUMBER	(3) DESCRIPTION REFERENCE NUMBER	(4) MODELS USABLE ON	(5) UNIT OF ISSUE	(6) QTY INC IN UNIT PACK	(7) 30-DAY DS/GS MAINT ALW (A) (B) (C) 1-20 21-50 51-100			(8) 1-YR ALW PER 100 EQUIP CNTGCV	(9) DEPOT MAINT ALW PER 100 EQUIP	(10) ILLUSTRATION (A) (B) FIG ITEM NO NO	
GROUP 05 VIBRATION METER (CONTINUED)														
P	F		6625-070-7923	IN66A (14028)		EA	4	*	*	*		*	11	23
P	F		5905-279-3513	RC20GF221J (81349)		EA	1	*	*	*		*	11	24
P	F		5905-073-5443	RC42JGF473J (09384)		EA	1	*	*	*		*	11	25
P	F		5930-823-0575	29037 (09384)		EA	1	*	*	*		*	11	26
P	F		5905-279-3495	RC20GF753J (81349)		EA	1	*	*	*		*	11	27
P	F		5905-185-8510	RC20GF103J (81349)		EA	1	*	*	*		*	11	28
P	F		5905-299-1965	RC20GF301J (81349)		EA	1	*	*	*		*	11	29
P	F		5905-279-3519	RC20GF220J (81349)		EA	1	*	*	*		*	11	30
P	F		5960-262-0286	MIL1TYPE565/WA (81349)		EA	1	*	*	*		*	11	31
P	F		5960-188-3551	MILE1-47-6AK6 (81349)		EA	1	*	*	*		*	11	32
P	F		5960-188-0880	6X4W (81349)		EA	1	*	*	*		*	11	33
P	F		5960-082-4139	5751 (81349)		EA	1	*	*	*		*	11	34
P	F		5960-166-7664	12AX7 (81349)		EA	2	*	*	*		*	11	35
P	F		5950-849-1096	34599 (14028)		EA	1	*	*	*		*	11	36
P	F		5910-893-9830	HC1060A (37942)		EA	1	*	*	*		*	11	37
P	F		5905-190-8889	RC20GF101J (81349)		EA	1	*	*	*		*	11	38
P	F		5910-850-1388	TVL2764HKT (56289)		EA	1	*	*	*		*	11	39
P	F		5930-823-0576	29038 (09384)		EA	1	*	*	*		*	11	40
GROUP 06 TERMINAL BOARD ASSEMBLY														
P	F		5905-279-2515	RC20GF474J (81349)		EA	1	*	*	*		*	12	1
P	F		5905-192-0667	RC20GF224J (81349)		EA	2	*	*	*		*	12	2
P	F		5905-279-2522	RC20GF154J (81349)		EA	1	*	*	*		*	12	3

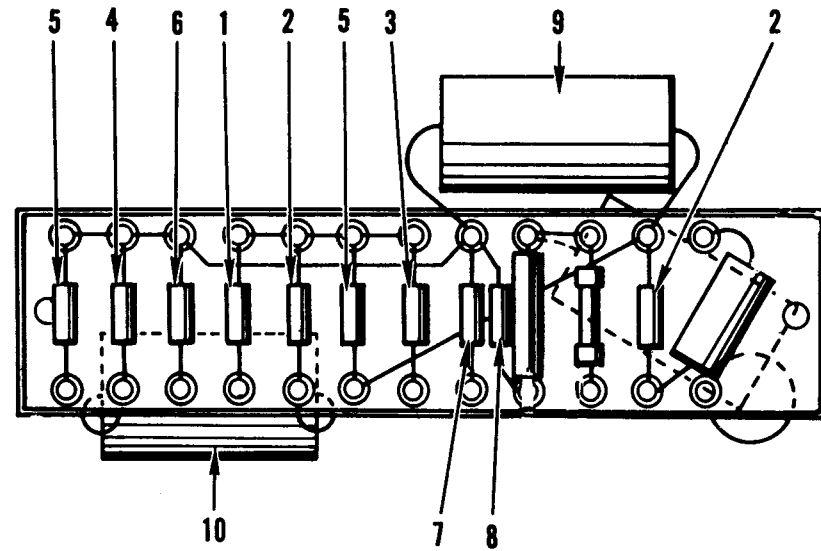

Figure 12. Terminal Board Assembly.

SECTION II

(1)			(2)	(3)		(4)	(5)	(6)	(7)			(8)	(9)	(10)		
SOURCE, MAINT AND REC CODE			FEDERAL STOCK NUMBER	DESCRIPTION	REFERENCE NUMBER	MODELS USABLE ON	UNIT OF ISSUE	QTY INC IN UNIT	QTY INC IN UNIT	30-DAY DS/GS MAINT ALW			1-YR ALW PER 100 EQUIP	DEPOT MAINT ALW PER 100 EQUIP	(A) FIG NO	(B) ITEM NO
(A) SOURCE CODE	(B) MAINT LEVEL	(C) REC CODE								(A)	(B)	(C)				
GROUP 06 TERMINAL BOARD ASSEMBLY (CONTINUED)																
P	F		5905-190-8885	RC20GF225J	(81349)		EA	1	*	*	*		*		12	4
P	F		5905-195-6761	RC20GF104J	(81349)		EA	2	*	*	*		*		12	5
P	F		5905-279-3503	RC20GF682J	(81349)		EA	1	*	*	*		*		12	6
P	F		5905-279-1876	RC20GF222J	(81349)		EA	1	*	*	*		*		12	7
P	F		5905-279-2519	RC20GF334J	(81349)		EA	1	*	*	*		*		12	8
P	F		5910-220-9475	BR845A	(14655)		EA	1	*	*	*		*		12	9
P	F		5910-617-4161	109P22494	(56289)		EA	1	*	*	*		*		12	10

STOCK NUMBER	FIGURE NUMBER	ITEM NUMBER	STOCK NUMBER	FIGURE NUMBER	ITEM NUMBER
4920-082-0436	2		5930-232-6545	11	1
4920-082-0440	8		5930-583-8861	11	16
4920-082-0446	3		5930-823-0575	11	26
4920-083-0409	1	3	5930-823-0576	11	40
4920-509-8078	5		5935-081-8025	1	1
4920-856-6088	4		5935-081-8025	1	8
4920-858-0016	6		5950-849-1096	11	36
4920-879-0331	1		5950-849-9394	11	21
4920-972-6118	7		5960-082-4139	11	34
4920-976-9318	10		5960-166-7664	11	35
4920-981-5089	1	2	5960-166-7664	7	7
4920-996-7421	9		5960-188-0880	11	33
5305-978-9343	4	5	5960-188-3551	11	32
5305-978-9343	5	1	5960-262-0286	11	31
5305-978-9343	6	5	6625-070-7923	11	23
5305-978-9343	7	3	6625-070-7925	11	22
5305-978-9343	10	1	6625-590-6502	11	
5306-297-0039	7	1	6625-899-8069	11	3
5306-826-3719	4	1			
5310-045-3298	6	3			
5310-061-7326	4	3			
5310-061-7326	7	3			
5310-061-7326	10	3			
5310-061-7326	12	3			
5310-167-0823	6	2			
5310-167-0834	4	2			
5310-180-0097	6	1			
5310-298-9267	4	4			
5310-298-9267	6	4			
5310-543-2410	4	5			
5310-543-2410	5	2			
5310-543-2410	6	6			
5310-543-2410	7	4			
5310-543-2410	10	2			
5330-579-3156	11	2			
5905-073-5443	11	25			
5905-185-8510	11	28			
5905-190-8885	12	4			
5905-190-8889	11	38			
5905-192-0667	12	2			
5905-195-6761	11	12			
5905-195-6761	12	5			
5905-249-3642	11	14			
5905-249-3656	11	10			
5905-249-3661	11	11			
5905-256-3361	11	13			
5905-279-1876	12	7			
5905-279-1937	11	15			
5905-279-2515	11	9			
5905-279-2515	12	1			
5905-279-2518	11	8			
5905-279-2519	12	8			
5905-279-2522	12	3			
5905-279-3495	11	27			
5905-279-3503	12	6			
5905-279-3505	11	7			
5905-279-3513	11	24			
5905-279-3519	11	30			
5905-299-1965	11	29			
5905-899-5035	11	4			
5910-220-9475	12	9			
5910-617-4161	12	10			
5910-849-5205	11	6			
5910-850-1388	11	39			
5910-893-9830	11	37			
5910-899-7112	11	5			
5920-280-8342	11				
5920-280-8344	11	20			
5920-636-4542		19			
5930-071-0924	11	18			
5930-201-4429	11	17			

REFERENCE NUMBER	MFG CODE	FIG NUMBER	ITEM NUMBER	REFERENCE NUMBER	MFG CODE	FIG NUMBER	ITEM NUMBER
AGC1-2	71400	11	20	109P22494	56289	12	10
AN101014	88044	7	1	109P68394	56289	11	6
AN101020	88044	4	1	11SMIT	91929	11	16
AN315-8R	88044	4	4	12AX7	81349	11	35
AN315-8R	88044	6	4	12AX7	81349	7	7
AN3420-3	09384	2	13	166648-1304	09834	2	9
AN3420-4	09384	2	14	169760-0036	09384	2	
AN8-23A	88044	6	1	171170-0104	09384	1	
AN960-10L	88044	4	2	28103	09384	2	11
AN960-816	88044	6	2	29037	09384	11	26
BR845A	14655	12	9	29038	09384	11	40
CEC171574	14028	7		30606	09384	11	18
CEC171575	14028	6		30624	09384	11	4
CEC171576	14028	5		31833	09384	2	12
CEC171578	91547	9		33356	09384	11	21
CEC171579	14028	4		342001	75915	11	19
CEC171580	14028	10		34599	14028	11	36
CEC171581	14028	1	1	34605	55026	11	3
CEC171581	14028	1	8	360069	55026	11	3
CEC49657-0300	14028	1	3	360081	09384	2	4
F02A250V1A	81349	11		360090	09384	2	8
HC1060A	37942	11	37	360282	09384	2	5
IN536	14028	11	22	360283-0003	09384	2	1
IN66A	14028	11	23	361597	09384	2	2
JS5	91929	11	17	362854	09384	8	
MILE1-47-6AK6	81349	11	32	362855	09384	3	
MILITYPE565/WA	81349	11	31	363129	09384	2	6
MS16997-10	96906	4	5	363170	09384	2	7
MS16997-10	96906	5	1	4-128-0101	09384	2	
MS16997-10	96906	6	5	49657-0900	09384	1	2
MS16997-10	96906	7	3	5751	81349	11	34
MS16997-10	96906	10	1	6X4W	81349	11	33
MS21045-3	96906	4	3	8280K14	15605	11	1
MS21045-3	96906	7	3	85529-7200	09384	2	10
MS21045-3	96906	10	3				
MS21045-3	96906	12	3				
MS288775-116	96906	11	2				
MS35337-48	96906	6	3				
MS35338-40	96906	4	5				
MS35338-40	96906	5	2				
MS35338-40	96906	6	6				
MS35338-40	96906	7	4				
MS35338-40	96906	10	2				
RC20GF101J	81349	11	38				
RC20GF103J	81349	11	28				
RC20GF104J	81349	11	12				
RC20GF104J	81349	12	5				
RC20GF154J	81349	12	3				
RC20GF220J	81349	11	30				
RC20GF221J	81349	11	24				
RC20GF222J	81349	12	7				
RC20GF224J	81349	12	2				
RC20GF225J	81349	12	4				
RC20GF301J	81349	11	29				
RC20GF334J	81349	12	8				
RC20GF392J	81349	11	7				
RC20GF434J	81349	11	8				
RC20GF474J	81349	11	9				
RC20GF474J	81349	12	1				
RC20GF623J	91349	11	10				
RC20GF682J	81349	12	6				
RC20GF683J	81349	11	11				
RC20GF753J	81349	11	27				
RC42GF102J	81349	11	3				
RC42GF200J	81349	11	15				
RC42GF393J	81349	11	14				
RC42JGF473J	09384	11	25				
TVL2764HKT	56289	11	39				
XK3-12	09384	2	15				
1-117-0105	09384	11					
109P10494	56289	11	5				

By Order of the Secretary of the Army:

W. C. WESTMORELAND,
General, United States Army,
Chief of Staff.

Official: .

KENNETH G. WICKHAM,
Major General, United States Army,
The Adjutant General.

DISTRIBUTION:

To be distributed in accordance with DA Form 12-31 requirements for Direct and General Support Maintenance Instructions for OV-1, UH-1A, -1B, -1C, -1D, AH-1G and CH-47 aircraft.

616-314

TM 55-4920-243-35P MONITORING KIT, VIBRATION P/N 171170-0104 FEDERAL STOCK NUMBER 4920-879-0331 -- 1968